

TYPICAL PAVEMENT CROSS-SECTION WITH INTEGRAL CURB/GUTTER OR ROLLED CURB FOR USE IN COMMERCIAL/INDUSTRIAL DISTRICTS (60 FT. RIGHT-OF-WAY)
N.T.S.

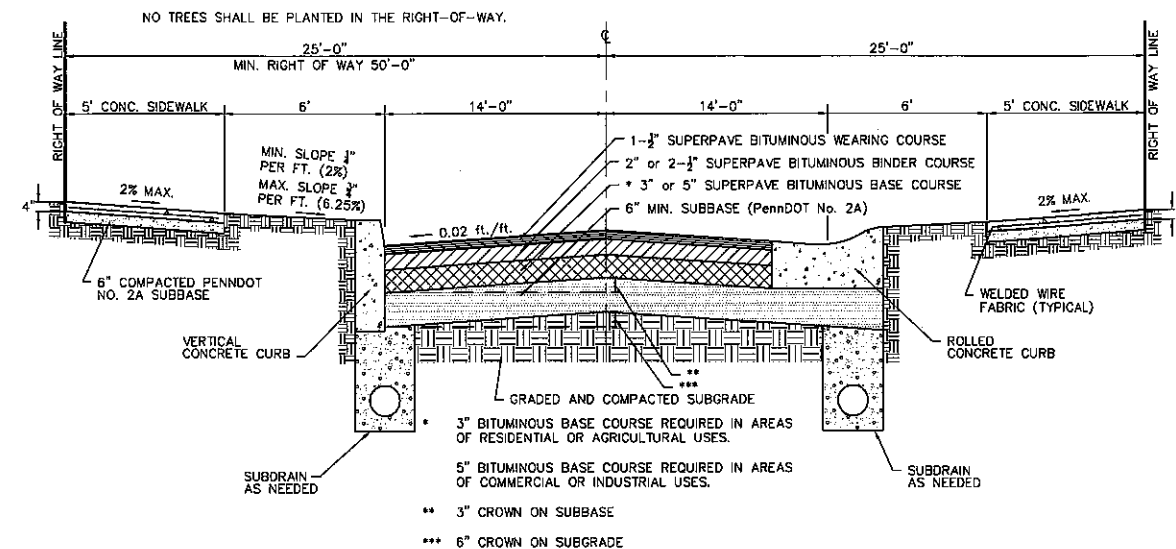

TYPICAL PAVEMENT CROSS-SECTION WITH VERTICAL CURB OR ROLLED CURB FOR USE IN RESIDENTIAL DISTRICTS (50 FT. RIGHT-OF-WAY)
N.T.S.

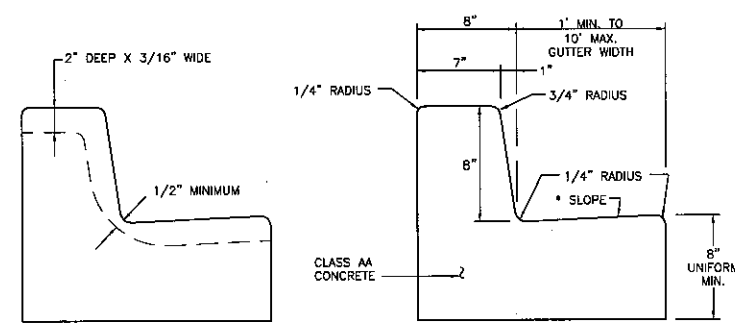

TYPICAL CROSS SECTION

UNDER 5' GUTTER WIDTH = 1" PER FT. MIN.

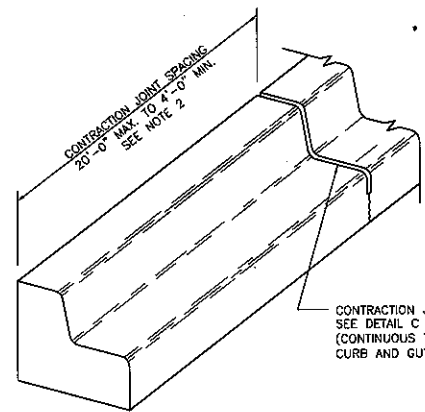

INTEGRAL CONCRETE CURB/GUTTER FOR USE IN RESIDENTIAL DISTRICTS
N.T.S.

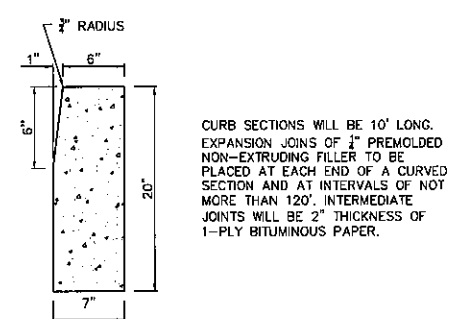

VERTICAL CONCRETE CURB FOR USE IN RESIDENTIAL DISTRICTS
N.T.S.

CURB SECTIONS WILL BE 10' LONG. EXPANSION JOINTS OF 1" PREMOULDED NON-EXTRUDING FILLER TO BE PLACED AT EACH END OF A CURVED SECTION AND AT INTERVALS OF NOT MORE THAN 120'. INTERMEDIATE JOINTS WILL BE 2" THICKNESS OF 1-PLY BITUMINOUS PAPER.

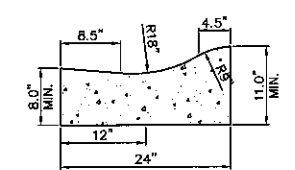

- NOTES:**
1. PROVIDE MATERIALS AND CONSTRUCTION MEETING THE REQUIREMENTS OF PUBLICATION 408, LATEST EDITION, SECTION 630 FOR PLAIN CONCRETE CURB AND DEPRESSED CURB, SECTION 640 FOR PLAIN CONCRETE CURB AND FOR PLAIN CONCRETE CURB GUTTER.
 2. SPACE CONTRACTION JOINTS IN UNIFORM LENGTHS OR SECTIONS.
 3. PLACE 3/4" PREMOULDED EXPANSION JOINT FILLER MATERIAL AT STRUCTURES AND AT THE END OF THE WORK DAY. CUT MATERIAL TO CONFORM TO AREA ADJACENT TO CURB OR TO CONFORM TO CROSS SECTIONAL AREA OF CURB.
 4. MECHANICAL SLIP FORM CURB MACHINE MAY BE USED TO CONSTRUCT CURB.
 5. ROLLED CONCRETE CURB DETAIL ADAPTED FROM MILLCREEK TOWNSHIP CONSTRUCTION STANDARDS - STANDARD DESIGN MOUNTABLE CURB AS DESIGNED BY HILL ENGINEERING, INC.

ROLLED CONCRETE CURB FOR USE IN RESIDENTIAL AND COMMERCIAL/INDUSTRIAL DISTRICTS
N.T.S.

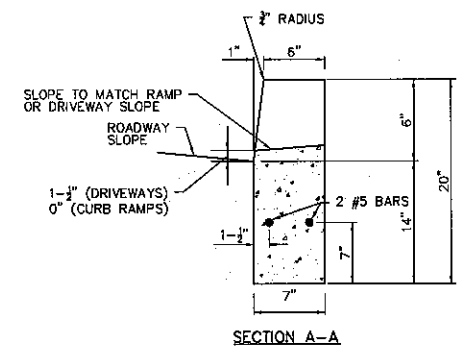

DEPRESSED CURB
N.T.S.

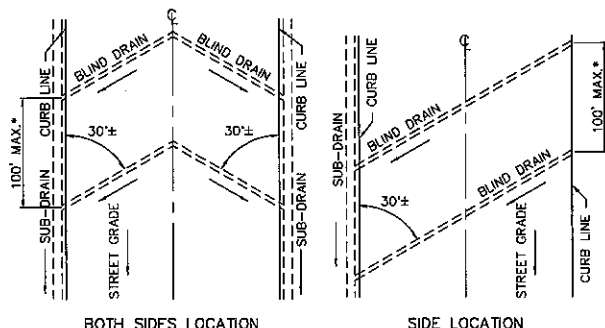

TYPICAL LOCATIONS FOR SUB-DRAINS AND BLIND DRAINS
N.T.S.

*THE REQUIRED INTERVAL FOR BLIND DRAINS SHALL BE RELATED TO GROUND WATER CONDITIONS AND SOIL TYPE, BUT IN NO CASE SHALL THIS INTERVAL BE GREATER THAN 100 FEET.

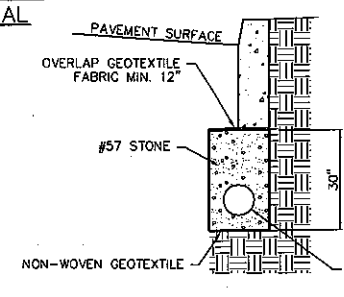

SUBDRAIN STANDARD
N.T.S.

- NOTES:**
1. 30" DEPTH HELD AS MINIMUM WHENEVER POSSIBLE. WHERE LOWER MINIMUM IS REQUIRED, INCREASE DEPTH BY USING A SLOPE LOWER THAN THE PAVEMENT DESIGN OR AS DIRECTED BY THE ENGINEER.
 2. WHERE PERFORATED STORM SEWER IS INSTALLED ALONG THE SIDE OF THE STREET, A SUBDRAIN IS NOT REQUIRED TO BE INSTALLED IN THAT LOCATION PROVIDED THE BLIND DRAINS FOR THE STREET ARE PROPERLY TIED INTO THE STORM SEWER.

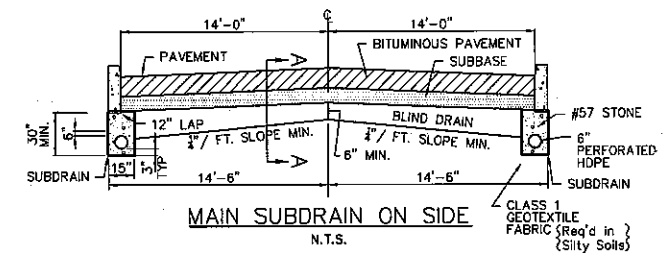

MAIN SUBDRAIN ON SIDE
N.T.S.

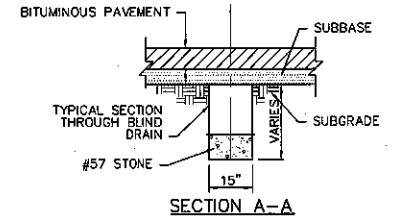

BLIND DRAIN
N.T.S.

STANDARD DETAILS FOR STORM SEWER AND PAVEMENT CONSTRUCTION

SUMMIT TOWNSHIP
ERIE COUNTY, PENNSYLVANIA
NOT TO SCALE
JULY 2012



October 08, 2013 - 2:58pm T:\2012\227226\03\03\03_SMT-Pavement_Std_Summit_Township.dwg 12/20/2012 10:00 CAD:\wp\227226\101010.dwg